

ROCKIN' RIDE HELMET

K0505



Installation, user and maintenance manual Instructions and warnings

M.P. GROUP srl – Via Boetti 16 – 42124 Z.I. Mancasale – Reggio Emilia – ITALY
tel.: +39 0522 273601 – fax: +39 0522 273610
e-mail: info@memopark.it -web: www.memopark.it

Company subject to management and coordination of ARIEL TECNICA S.p.A.
Via Quarto Negroni, 54 00040 Ariccia (RM) – Tax Payer's Code 07183350581
The MEMOPARK brand is the property of M.P. GROUP srl

Index

1 – Information for the recipient	6
1.1 Purpose of the manual	6
1.2 Machine and Manufacturer identification information	6
1.2.1 Manufacturer identification information	6
1.2.2 Machine identification information	7
1.3 Symbols	8
1.4 Warranty	9
1.5 Applied standards and laws	9
1.6 Copy of declaration of CE conformity	10
1.7 Requesting technical support and ordering replacement parts	11
1.8 Attached documentation	11
2 - Illustration of the product	12
and technical details	12
2.1 Main parts	12
2.2 General description	13
2.3 Intended use	13
2.4 Environmental operation limits	14
2.5 Safety and precaution devices	14
2.6 Residual risks	15
2.7 Technical data	16
2.8 Size and weight	16
3 - Safety	16
3.1 General warnings	16
4 - Installation	17
4.1 - Packaging	17
4.2 - Unpacking the machine	17
4.3 Storage of the machine	18
4.4 Lifting and handling	18
4.5 Lift with a forklift	19
4.5.1 Manual handling	19
4.6 Preparations under the care of the operator	20
4.7 Positioning of the machine	20
4.8 Electrical connection	21
4.9 Demolition and disposal	22

5 - Regulations and tuning	23
6 - Instructions for use and operation	24
6.1 Use of the machine	24
6.2 Start and stop	25
6.3 Token collection	26
6.4 Emergency situations	26
6.4.1 Stop due to loss of electrical power	26
7 - Maintenance	27
7.1 General precautions	27
7.2 Warnings	27
7.3 Disassembly the machine	28
7.4 Maintenance schedule	29
7.4.1 Tasks to be performed at the beginning of each shift	30
7.4.2 Cleaning and disinfecting	30
7.4.3 Visual check	30
7.4.4 Power cable check	30
7.4.5 Token slot check	31
7.4.6 Visual check of the electrical panel	31
7.4.7 Screw tightness	31
7.4.8 Sound check	31
7.4.10 Silent Block check	31
8 - Problems, causes and solutions	33
8.1 - Problems, causes and solutions	33
9 - Component replacement	34
9.1 Loudspeaker replacement	34
9.2 Fuse replacement	34
9.2.1 Replacement of fuse on logic board	34
9.3 Token slot check/replacement	34
10 - Technical Manual	35
10.1 Software settings	35
10.2 How to acces the settings procedures	35
10.3 Settings menu	36
10.4 Set coin per credit	36
10.5 Set audio volume	37
10.6 Statistics	37
10.7 License	38

10.8 Error code	39
10.8.1 Possible errors and solutions	39
10.9 Electrical wiring diagram	40
10.10 Computer diagram	41
10.11 Motors driver diagram	42
10.12 Front panel diagram	43
11 - product data sheet	44

Revision

Revision	Description	Date
00	Manual	06/09/2011

1 – INFORMATION FOR THE RECIPIENT

1.1 Purpose of the manual

This manual was prepared by the manufacturer and constitutes an integral part of the machine (1).

The information contained in this manual is intended for the operator to whom the machine is destined.

All rights of reproduction of this manual are reserved. Reproduction, even partial, is prohibited.

1.2 Machine and Manufacturer identification information

1.2.1 Manufacturer identification information

M.P. GROUP srl
Via Boetti, 16 Zona Industriale Mancasale
42124 Mancasale (Reggio Emilia) - Italy
Tel.: (+39) 0522/273601
Fax: (+39) 0522/273610
Internet: <http://www.memopark.it>
e-mail: info@memopark.it

Company subject to management and coordination of ARIEL TECNICA S.p.A.
Via Quarto Negroni, 54 00040 Ariccia (RM) – Tax Payer's Code 07183350581

The MEMOPARK brand is the property of M.P. GROUP srl

1.2.2 Machine identification information

The machine is identified by the markings punched on the tag which is fixed to the base.

(1) The definition of machine replaces the commercial denomination to which the manual in question refers (see cover).



Code: Serial number
V: Connection voltage 110/230 V
HZ: Frequency 50-60 Hz
A: Absorption
Kw: Maximum power absorbed

1.3 Symbols

The operator (2), prior to making the machine available to the public, must have read and understood the instructions contained in this manual and particularly the instructions highlighted by the symbols shown below.

(2) The operator is the person, agency or company which has purchased or rented the machine and intends to use it for the intended uses.



ATTENTION!

Indicates information or procedures which, if not performed carefully, may cause serious injury to the operator or other people.



CAREFUL!

Indicates information or procedures which, if not followed strictly, could also cause damage to the machine.



information

Indicates useful and important information or procedures.

In order to facilitate consultation the manual is subdivided into chapters which identify the main concepts. For a quick search of the issues, consult the descriptive index.



ATTENTION!

In this manual some illustrations show the machine with guards, casings or panels removed for the purpose of greater clarification in the description of the operations to be performed. Never use the machine if it is not equipped with all casings and guards.



The machine, the commercial denomination of which is shown on the cover, may sometimes differ in some aesthetic details.

1.4 Warranty

The machine is delivered in the valid conditions at the moment of purchase.

The warranty covers solely replacement of parts which are recognised as defective by the manufacturer free of charge.

The operator is not authorised for any reason whatsoever to tamper with/modify the machine.

Any attempt to alter, dismantle and modify or in general tamper with the machine and/or any of its components by the operator will void the warranty

The warranty is also void in case of (not limited to):

- improper use of the machine
- inadequate maintenance
- tampering or incorrect connection
- different power systems that those the machine has been prepared for
- failure to observe the instructions
- use of after market parts or parts which are not specifically for the model
- unauthorised modifications or operations
- exceptional events

1.5 Applied standards and laws

The applied standards and laws are indicated in the declaration of conformity attached to this manual.

1.6 Copy of declaration of CE conformity

Dichiarazione CE di conformità EC Declaration of Conformity

La sottoscritta
The undersigned

M.P. GROUP srl
Via Boetti 16
42124 Reggio Emilia – Italy

dichiara sotto la sua esclusiva responsabilità che il prodotto:
declares under his own responsibility that the:

Attrazione Modello:
Attraction Model:

codice:
code Nr:

N. di serie:
Serial Nr:

Anno di costruzione:
Year of construction:

Così come è stato consegnato è conforme alle seguenti direttive e successive modifiche:
As delivered, is in conformity with the requirements of the following Directives and further amendments:

- Direttiva 2006/95/CE Bassa Tensione
Directive 2006/95/EC Low tension
- Direttiva 2004/108/CE Compatibilità elettromagnetica
Directive 2004/108/EC Electromagnetic Compatibility

Ed inoltre dichiara che sono state applicate le seguenti norme armonizzate:
And that the following harmonized standards have been applied:

- Norma EN 61000-6-3 e EN 61000-6-1 Compatibilità elettromagnetica
Standard EN 61000-6-3 e EN 61000-6-1 Electromagnetic Compatibility
- EN 60204-1 "Sicurezza del macchinario – Equipaggiamento elettrico delle macchine"
Safety of machinery – Electrical equipment of machines Part 1: General requirements
- EN 60335-1 Sicurezza degli apparecchi elettrici d'uso domestico e similare – Parte 1: norme generali
Safety of household and similar electrical appliances. –Part 1: General requirements
- EN 60335-2-82 Sicurezza degli apparecchi elettrici d'uso domestico e similare – Parte 2: norme particolari per le macchine che forniscono un servizio e per le macchine da divertimento
Safety of household and similar electrical appliances. –Part 2: Particular requirements for amusement machines and personal service machines

Reggio Emilia (RE), Italy.....

M.P. GROUP **M.P. Group** s.r.l. Via Boetti, 16, 42010 Reggio Emilia Italy tel +39 0522 273601 fax +39 0522 273610
http://www.mppgroup-italy.com e-mail: info@mppgroup-italy.com C.F./P.IVA/Id. Fisc. Reg. Imp. IT 02812946951

Società iscritta a direzione e coordinamento di ARCL TECNICA SpA
Via Quarto Negroli, 54 00040 Ariccia (RM) C.F. 07163350501 Tel.: +39 069020261 Fax: +39 069020202

MERIDIAN **V.S.V. LIGHT**

1.7 Requesting technical support and ordering replacement parts

In case of break downs or abnormalities for which qualified technical personnel are required and for ordering replacement parts, see the manufacturer or reseller directly, specifying the information indicated on the identification tag.

1.8 Attached documentation

The following documentation is attached to this manual:
EC declaration of conformity

2 - ILLUSTRATION OF THE PRODUCT AND TECHNICAL DETAILS

2.1 Main parts

Fig. 1

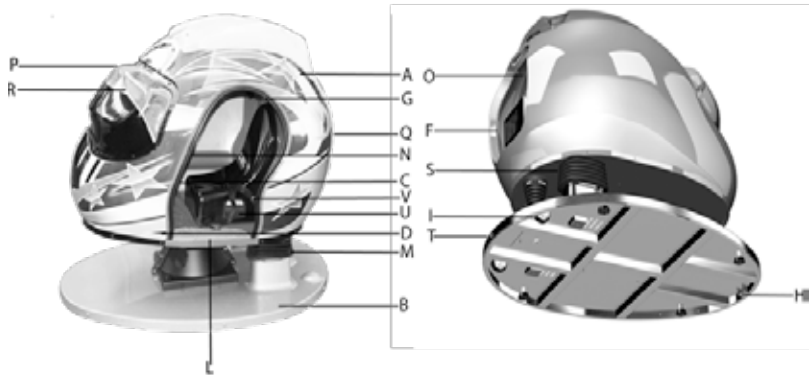

Main parts key

- A - Figure in fiberglass
- B - Base
- C - Coin Acceptor
- D - Token collection door
- E - Feet
- F - Positioning of electronic components
- G - Voltage indicator light
- H - Hole for manual handling
- I - Wheels
- L - Anti slip footboard
- M - Bellows
- N - Button for movie selection
- O - Fan
- P - Visor
- Q - Rear door
- R - Monitor
- S - Linear actuator
- T - Power supply cable
- U - Side handles
- V - Safety seat belt

2.2 General description

For references see fig. 1

The game consists of a helmet in resin (A) mounted on an oscillating base driven by two linear actuators (S) and the child sits inside the helmet on the appropriate seat.

On the internal monitor of the helmet a movie runs (you can choose from multiple movies, up to a maximum of 4);

The on-board computer processes the input received from the movie and returns as output of actuators in the form of speed and acceleration. In this way it reproduces an environment that tends to simulate entirely the movie projected on the screen thus transferring the child, inside the helmet, all those sensations of movement that are visually perceived watching to the movie.

The area under the figure is housed the ball joint which allows movement of the game.

The figure is supported by a base (B) equipped with wheels (I) to move in short spaces and adjustable feet (E) to locate it on the ground.

All mechanical, electrical and electronic equipments involved in the operation of the machine are isolated and protected from accidental manipulation by the public. The machine is equipped with a fan which enter air inside the game through a conveyor

2.3 Intended use



ATTENTION!

Use is permitted for children in the following combinations:

- a maximum of one child;
- children between the ages of 3 and 10 and weighing less than 60 kg.

The child must be under the constant supervision of an adult.

The machine was designed and built to be installed in a covered area.

Any use different from that declared is to be considered "improper use" and is therefore not permitted.

2.4 Environmental operation limits

The machine is equipped with electrical parts which are adequately protected from humidity.

The machine can be installed in public places (i.e.: game rooms, shopping centres) and must be installed indoor.

- *Operational ambient temperature: from + 5 °C to + 40 °C.*

- *Relative humidity: from 40% to 90%.*



ATTENTION!

EXPLOSIVE ATMOSPHERE.

This attraction is not realized in Ex (explosion proof) fitting, but in standard fitting. Therefore installation and operation in environments which may generate an atmosphere of deflagration (explosion) IS PROHIBITED.



2.5 Safety and precaution devices

For references see fig. 1

D - Door with key

Prevents access to the token/coin box by unauthorised personnel. Verify that the lock closes correctly.

G - Voltage indicator light

When on indicates the presence of electrical voltage to the machine.

L - Anti slip footboard

Prevents the child from slipping while entering and exiting the figure.

M - Bellows

Protect from risk of accidental contact with the parts in motion located underneath the figure in motion.

Replace in case of tears greater than 5 mm.

Q - Rear door with key

Prevents access to electronics and power supply by unauthorised personnel.

Verify that the lock closes correctly.

U - Side handles

The child can also hold himself tightly to the side handles for further safety.

V - Safety seat belt

The child must fasten the seat belt for further safety.

Do not tamper the safety devices for any reason.

Prior to daily start-up of the machine a careful check must be performed to ensure that the safety devices are in proper working order.

Use of the machine with safety devices not in proper working order is strictly prohibited.

The doors with keys (where present) must always be closed during operation of the machine.

The opening/closing key for the doors (where present) must be kept by an appointed manager.

2.6 Residual risks

In spite of observance of all safety standards and use of the machine in accordance with the rules described in this manual, the following residual risks still exist:

- child falling while coming in and going out the ride; help the child during entrance and exit holding by the hand or picking up.
- child falling during oscillation of the figure; ensure that the child stays properly seated. During the ride the accompanying adult must stay close to the child and aid or hold the child up if necessary.
- child slipping and falling against the machine; when the machine is in operation no one must be in the respect area except the accompanying adult, who must in any case be careful not to bump the machine during movement.

2.7 Technical data

Vibrations

In conditions of use in compliance with the indications for correct use the vibrations are minimal.

In the event of sudden vibrations the operator must immediately stop the machine and report the phenomenon to the manufacturer.

Noise

The machine is designed in such a way to reduce the noise level.

In conditions of use conforming with the correct use instructions, the noise level is less than 80 dB(A).

2.8 Size and weight

Please refer to technical data sheet at sect.11 of this manual.

3 - SAFETY

3.1 General warnings



ATTENTION!

Read the instructions in this manual carefully, particularly the instructions on safety and signs applied to the machine.

- Do not use the machine without the safety devices and guards.
- Ensure that the machine power cable does not create a tripping hazard to passing foot traffic.
- The machine must not be installed in abandoned and/or unsupervised locations.
- The location where the machine is installed must be protected against atmospheric discharges (lightning).
- The location where the machine is installed must be equipped with emergency ambient lighting.
- Do not make any modifications to the machine.
- In case of fire do not use water. Use extinguishers (not foam type). Do not aim the extinguisher jet at any passengers.

4 - INSTALLATION

Fig. 2

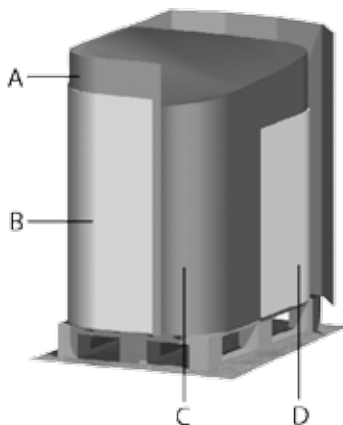

- A - Carton
- B - Plastic film
- C - Machine
- D - Plastic film

4.1 - Packaging

The machine is packaged individually and already assembled.
The machine is wrapped in an extendible nylon film, covered with a carton and wrapped in plastic film.

4.2 - Unpacking the machine

Remove the packaging (plastic film and carton) being careful while opening the package not to damage the machine.



Separate the various elements which make up the packaging for the purpose of facilitating elimination or recycling in observance of the prevailing local regulations.

4.3 Storage of the machine

Store the machine in an adequately protected area in a indoor location protected from the elements.

The ambient temperature must be between - 10 °C and + 50 °C with maximum relative humidity 90% without condensation.



ATTENTION!

Do not place the packaging on top of each other because it does not have the construction characteristics for stacking.

Ensure that the floor is adequately rated to safely support the weight of the machine or the stored machines.

4.4 Lifting and handling



ATTENTION!

The personnel in charge of handling operations of the machine must perform the mentioned operations with maximum caution and attention in order to avoid damage to persons and/or things.

The operator is the primary person responsible if these indications are not performed or if they are neglected by any worker.

The staff in charge of unpacking, lifting and handling operations of the machine must wear suitable Personal Protection Devices.

The staff operating the machine must be authorized by the Customer and must be qualified to work on it, according to the local safety standards and the instructions included in this manual.

Ensure that no one is near the machine during lifting and transportation of the machine.

Always verify that the forklifts are adequately rated for the weight to be lifted. For the size and weight please refer to the product data sheet in section 11 of this manual.

Lifting the machine by the fibreglass figure (A) is prohibited. This could cause injury or the machine could be damaged. Lift the machine by the base (B).

4.5 Lift with a forklift

Fig. 3



1. Introduce the forks of the forklift under the machine being careful not to damage the feet and the wheels. Pay attention to balancing the weight: introduce the forks trying to position them in an equidistant way from the centre of the machine or the pallet.
2. Lift the machine for 8 cm.

4.5.1 Manual handling

The machine can be moved from one place to another using the cart provided on request or pushing the machine by hand at the base.

Fig. 4



4.6 Preparations under the care of the operator

ATTENTION!

Electrical installation must always be performed by a qualified technician.

The operator must prepare:

- the electrical line to which the machine will be connected.

The system must:

- comply with the local prevailing norms on installation of the machine;
- be provided with adequately rated cable for the power absorbed by the machine (see the identification tag) and the length of the system itself;
- have an efficient earthing system;
- be equipped with an IdN 0.03 A GFCI (general failure circuit interrupt) breaker.

Do not connect more than one machine to the GFCI.

4.7 Positioning of the machine

Position the machine using the forklift as indicated in point 4.5 and 4.5.1.

Place the machine on the ground and level it by adjusting the four feet (Fig.3-5), making sure that the machine is stable.

The adjustment is made from the top by removing the plastic cap and using a screwdriver on the head of the foot.

Fig. 5

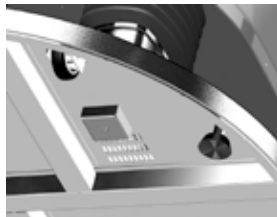

The connection cable must not be run over the ground in areas where vehicles or people transit in order to prevent it being crushed or creating an obstacle or hazard.

The machine must be positioned on a flat, solid surface and must have a sufficiently perimetral area of respect of 50 cm.

Fig. 6



Area of respect: area within which a person may be bumped by the machine's motion.



ATTENTION! _____

Do not install the machine in an environment with danger of explosion.

The area chosen for installation must have:

- a flat and solid surface with adequate load bearing capacity;
- a perimeter area sufficiently wide for any safe operations required;
- the maximum allowable slope for the installation surface is $\pm 2^\circ$.

4.8 Electrical connection



CAREFUL! _____

Verify that the line voltage (V) and frequency (Hz) correspond to the indications on the identification tag. A tolerance of $\pm 10\%$ is permitted with respect to the rated line voltage. In case of greater tolerance contact Manufacturer technical support for the necessary adjustments in order to guarantee regular operation of the machine. Before inserting the plug ensure that the switch upstream of the outlet is disconnected.

The use of multiple plugs, adaptors and/or extension cords is prohibited.

Connect the plug to the prepared mains outlet.

The machine is powered with an H07 RN-F cable classes.

The electric system upstream of the machine must be equipped with an IdN 0.03 A GFCI.

- The ride is placed on the ground on the power cable.
- The metallic parts of the machine must not be placed further on the ground.
- The machine has a class I insulation level.

To check whether or not the machine is connected correctly verify that the electrical voltage power indicator light is on (G fig. 1).

4.9 Demolition and disposal

Rubber, plastic, fibreglass, oils and grease are considered special waste, therefore they must be disposed of in accordance with the prevailing standard in the country where the machine is used.

- 1) Disconnect the machine from the electrical energy source.
- 2) Dismantle the machine and separate the various elements based on their nature. Send the various elements to authorised collection centres in observance of the prevailing laws in the country where the machine is used.



5 - REGULATIONS AND TUNING



ATTENTION!

All of the electrical adjustments must be done with the machine stopped and disconnected from the mains power except for the volume adjustment.

The ride is driven by an electronic board located in the front part of the resin which controls the following parameters:

- ride time (begins from the moment the tokens are inserted)**
- coins/tokens inserted for each ride**
- programming of the costs for an individual ride**
- volume.**

For instructions please refer to the Technical Manual, section 10.

6 - INSTRUCTIONS FOR USE AND OPERATION

6.1 Use of the machine

CAREFUL!

Ensure that the child is properly seated on the machine before inserting the coin/token into the slot.

Do not allow the child to enter or exit the machine while it is in motion.

Do not leave the child alone near or on the machine, whether stopped or in motion.

Fig. 7



Fig. 8



-
- 1 - Help the child enter taking him or her by the hand or lifting him or her up.
 - 2 - Ensure that the child is seated correctly.
 - 3 - Insert the token/coin into the coin/token acceptor and remain beside the child in order to follow him or her visually while the figure is in motion and, if necessary, aid and support the child.
 - 4 - At the end of the ride help the child exit taking him or her by the hand or lifting him or her up.

6.2 Start and stop

Fig. 9

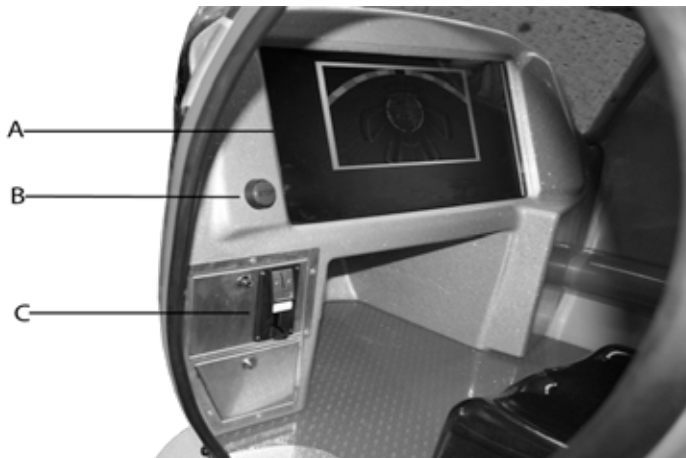

- A - Monitor
- B - Start button
- C - Coin acceptor

Enter one or more coins / tokens in coin acceptor (C) and press the button to start the run.

The figure starts moving while the music begins.

The machine stops automatically when the set ride time is over.

6.3 Token collection

Collection of tokens must be done with the machine stopped.
The key to the token box must be kept by authorized personnel.

- 1) Open the door with the special key.
- 2) Extract the token/coin box usually located under the steering wheel and remove the contents.
- 3) Replace the box and close the door with the key.

6.4 Emergency situations

6.4.1 Stop due to loss of electrical power

If the power fails the machine stops and keeps that position even when power is restored.

Credit will automatically cleared, therefore another token/coin must be inserted to restart the machine.

7 - MAINTENANCE

7.1 General precautions

Before proceeding with any type of operation having to do with maintenance, you must:

- read the instructions in this manual carefully.
- switch the machine off

During each operation you must:

- use original replacement parts
- use suitable tools in good repair
- observe the schedules for the various checks and maintenance operations
- faithfully follow the instructions in this manual.
- use the required Personal Protection Devices.

After each operation you must:

- before closing panels or casings check that no tools or parts have been left inside them.

7.2 Warnings



ATTENTION!

All of the maintenance operations described below must be done by qualified personnel (3) with the machine stopped and disconnected from the mains power and in observance of the injury prevention standards.

(3) Qualified personnel means those people who possess the professional prerequisites suited for the work to be performed.



ATTENTION!

Each time the machine is operated on for maintenance, the "maintenance in progress" sign must be prominently displayed.

7.3 Disassembly the machine

Fig. 10

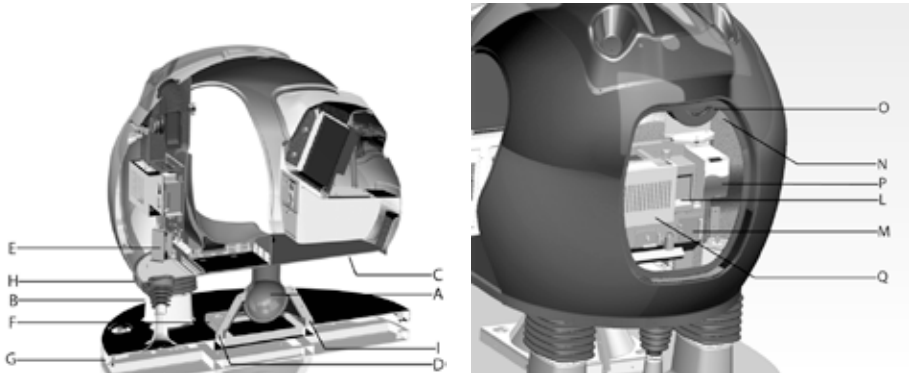

- A - Ball Joint
- B - Linear Actuator
- C - Plan Mobile
- D - Thermoforming
- E - Silentblock
- F - Caps protection bolt M6
- G - Fixing screws of the cover of the basement No 10 bolts M6x20
- H - Mounting screws the cap on the mobile No 11 TT bolts M6x20
- I - Fixing screws of the thermoforming 14 bolts M6x16
- L - Fuse
- M - Data Pilot
- N - Speakers
- O - Fun
- P - Power
- Q - Computers

To carry out the maintenance of the mechanical parts, take off the figure in resin.

- 1 - Loosen the screws (G) of the resin to the moving plate as shown in Fig. 10.
- 2 - raise the figure

To make the lubrication of plastic thermoforming remove the carpets and the screws (I), remove the thermoforming and lubricate with silicone grease to the top of the ball.

For installation of the machine repeat the steps in reverse.

7.4 Maintenance schedule

Activity	Frequency						Without the obligation to record in the Log Book
		daily	monthly	quarterly	semi annual	annually	
Cleaning and disinfecting		X					X
Visual check		X					X
Mains cable Check		X					X
Token slot Check		X					X
Electrical panel Visual check				X			X
Screw tightness Inspection					X		
Lights and sounds Check					X		
Control wear and lubrication thermoforming					X		
Silentblock Check						X	
Bellows Check					X		
Replacement Air Filter			X				
Annual inspection						X	

7.4.1 Tasks to be performed at the beginning of each shift

1. Perform cleaning and disinfecting of the machine.
2. Verify the integrity of the electrical power cable.
3. Check that the token/coin slot is not blocked.
4. Perform a visual inspection for the purpose of noting any anomalies.
5. Check the efficiency of the guards and the safety systems.
6. Check operation of the power indicator light.

The operations described above do not need to be recorded in the log book.

7.4.2 Cleaning and disinfecting



ATTENTION!

Disconnect the machine from the electrical power mains.

Do not wash the machine with a jet of water.

Do not wash the machine with aggressive or flammable substances.

Use products specifically intended for the surfaces to be cleaned.

Clean the hand grips and the seat at least one a day with hygienizing products.

7.4.3 Visual check

The check consists in:

- 1 - verifying that there are not tears, folds or other damage to the machine and that the safety systems are operating properly.
- 2 - checking the stability of the machine and if necessary acting on the adjustable feet.

7.4.4 Power cable check

The check consists in:

- 1 - verifying that the cables are not damaged and/or tampered with
- 2 - verifying that the cable is not stretched

7.4.5 Token slot check

The check consists in:

1 - inserting a token/coin into the slot and ensuring that it is not blocked.

7.4.6 Visual check of the electrical panel

The check consists in:

1 - verifying the integrity of the electrical cables

2 - verifying that the connectors are secured

7.4.7 Screw tightness

Check the tightness of the screws indicated in fig. 10.

7.4.8 Sound check

The control consists of:

1 - insert a coin / token into the slot and check that the movie runs and to listen to the music.

7.4.9 Wear and lubrication thermoforming check

The control consists of:

visual inspection and lubrication of the next part of thermoforming in contact with the ball joint with silicone grease.

7.4.10 Silent Block check

The control consists of:

verify the visual integrity of the joint between the rubber and the metal part of the silent block.

In the case highlighted the divisions in the rubber part replacement is necessary.

7.4.11 Bellows check

The control consists of:

verify the visual integrity of the bellows.

In the case highlighted lacerations in the rubber part the replacement is necessary.

7.4.12 Replacement Air Filter

At the intervals shown in the table to perform maintenance to replace the air filter.

7.4.13 Annual inspection

The machine must be subjected to an annual inspection based on the prevailing standard.

The inspection must be performed by a certified technician.

.

8 - PROBLEMS, CAUSES AND SOLUTIONS

8.1 - Problems, causes and solutions

PROBLEM	PROBABLE CAUSE	ACTIONS
The ride does not work	There is no 230V power supply	Wait for power to be restored.
	Power intake fuse is interrupted	Replace the fuse see fig. 10
	Computer failure	Check the PC-power supply located behind it.
Black Screen	Check the LCD power supply	Replace the LCD monitor
	Computer failure	Replace the computer
The ride does not accept the coins	Token slot blocked	Verify that the token slot is not blocked
		Replace the token slot with another equivalent
The ride accepts the coins, the music plays, but the ride does not move	24VDC power supply failure	Check the green light on 24VDC power supply
	24VDC power supply failure	Replace the power supply
Incorrect movements	Linear Actuator failures	Replace the actuator
	Linear Actuator driver board failure	Replace the electronic board
The music does not work	Incorrect volume adjustment	Adjust the volume (see technical manual)
	Loudspeaker defect	Replace the loudspeaker
Vibration	Silent Block is broken	Replace the silent block
The ventilation system is not working	Ventil is broken	Replace the ventil
	Filter clogging	Replace the filter

9 - COMPONENT REPLACEMENT



CAREFUL!

Replacement of components must be carried out exclusively with original parts by authorised personnel.



ATTENTION!

Disconnect the machine from the electrical power mains.

9.1 Loudspeaker replacement

- 1 - remove the grille of the hole containing the Loudspeaker
- 2 - Check the loudspeaker
- 3 - Replace the loudspeaker

9.2 Fuse replacement



ATTENTION!

Before proceeding with any fuse replacement the cause of the blown fuse must first be eliminated. Furthermore, the fuse must be replaced with another one with the same characteristics.

9.2.1 Replacement of fuse on logic board

- 1 - Open the rear door.
- 2 - Access to the logic control panel and remove the fuse
- 3 - Replace the fuse with a new one having the same characteristics: 10 A (500 V) - CH10
- 4 - Replace the fuse and close the door.

9.3 Token slot check/replacement

- 1 - Unscrew the 4 securing screws from the column.
- 2 - Check that the token slot is not obstructed
- 3 - Replace the token slot if defective.





10 - TECHNICAL MANUAL

10.1 Software settings

In this section :

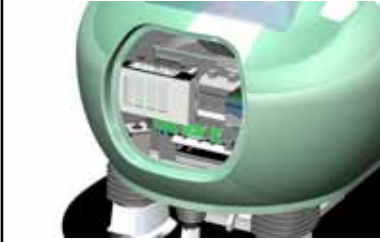
- Change the price per ride
- Adjust the sound volume
- Read usage statistics
- Manage the license system

10.2 How to acces the settings procedures

	<p>Tools needed: USB Mouse USB Keyboard</p>
	<p> ATTENTION ! High voltage inside</p> <p> ATTENTION ! Do not open while operating</p>
	<p>Connect mouse and keyboard to the USB ports, you don't need to re-boot the operating system.</p>
	<p>Double click on the RED are (at the top right corner)</p>

10.3 Settings menu

The settings menu consist of 4 tables: PRICE, AUDIO, STATS and LICENSE



Settings menu, window overview

10.4 Set coin per credit

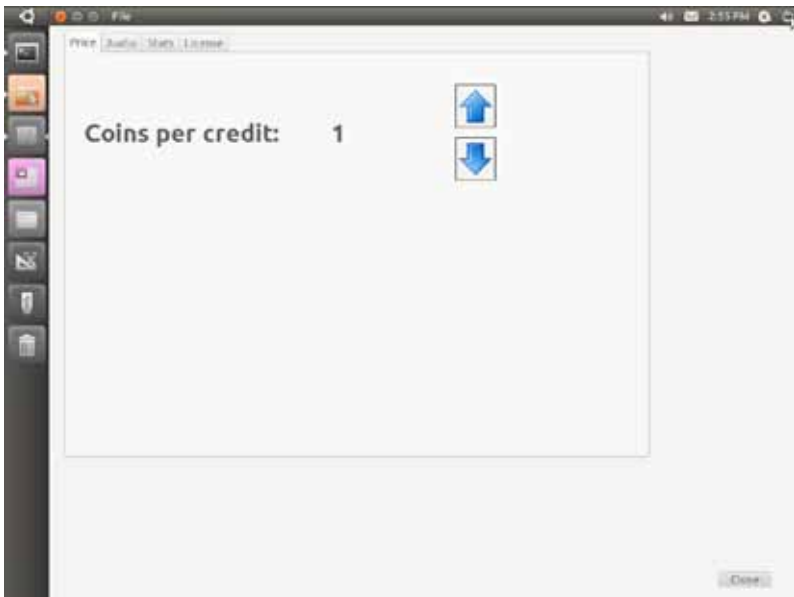

TAB - PRICE (Price Match)

Allows you to set how many credits are needed for a game.

To change the value, use the buttons in the shape of an arrow, the UP-ARROW button increases the value, the button-DOWN ARROW decrements it.

A value of "Coins for credit" = 0 sets the game in FREE MODE

10.5 Set audio volume

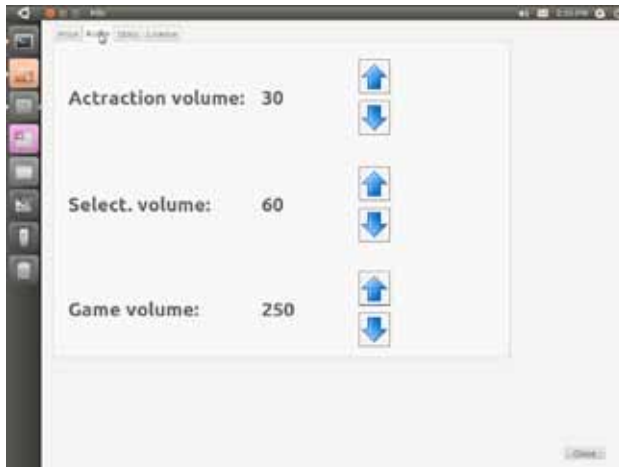

TAB - AUDIO

Allows you to set, in different ways, the sound volume during the demo, while selecting the movie (only in certain markets) and during the ride. Acting on the corresponding buttons to increase or decrease the value.

10.6 Statistics

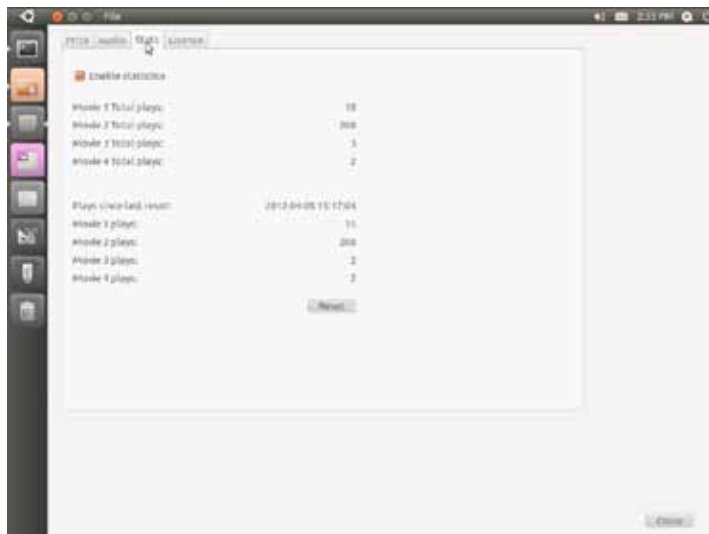

If you do not want to store this information, disable the feature by unchecking the “Enable statistics”

10.7 License

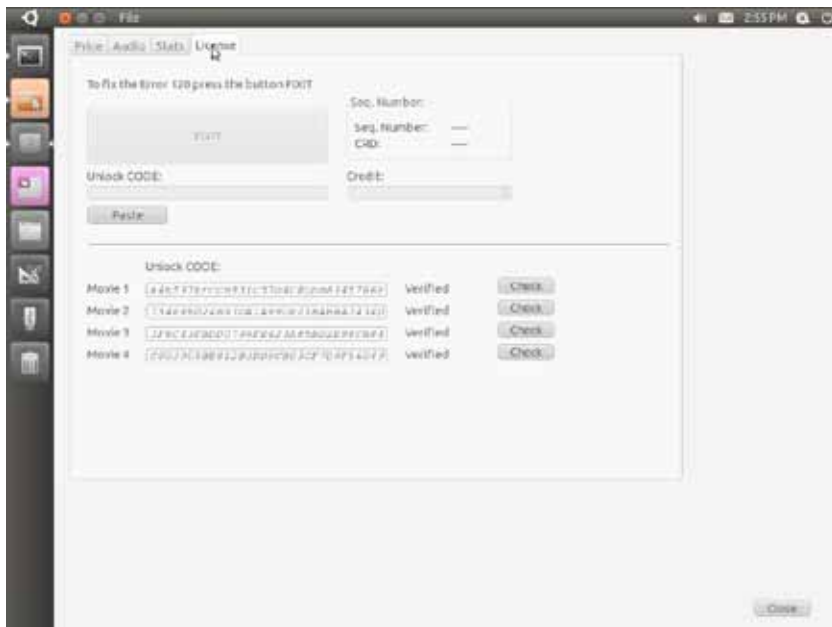



Under construction

10.8 ERROR CODE

10.8.1 Possible errors and solutions

If an error occurs, the RRH stops operating and indicates the error code on the display.

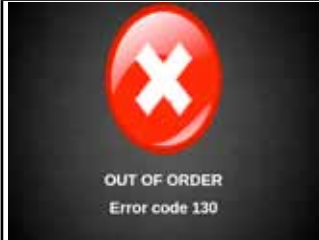
Screenshot	Description	Solution
	<p>OUT OF ORDER</p> <p>Comm port not found</p> <p>Serial port not found</p>	<p>Replace the PC</p>
	<p>OUT OF ORDER</p> <p>Motor control not responding</p> <p>The DKRATT board not responding</p>	<p>Check the connections on PC and DKRATT board</p> <p>Replace the DKRATT board!</p> <p>WARNING!</p> <p>After replace this components you MUST run the calibrate function!</p>
	<p>OUT OF ORDER</p> <p>Light control not responding</p> <p>the ARKA board not responding</p>	<p>Check the connections on PC and ARKA board</p> <p>Replace the ARKA board!</p> <p>WARNING!</p> <p>Before replace this components contact your local dealer</p>
	<p>OUT OF ORDER</p> <p>Error code 130</p> <p>Invalid license number, one or more movies are not registered</p>	<p>Contact your local dealer!</p>

10.9 Electrical wiring diagram

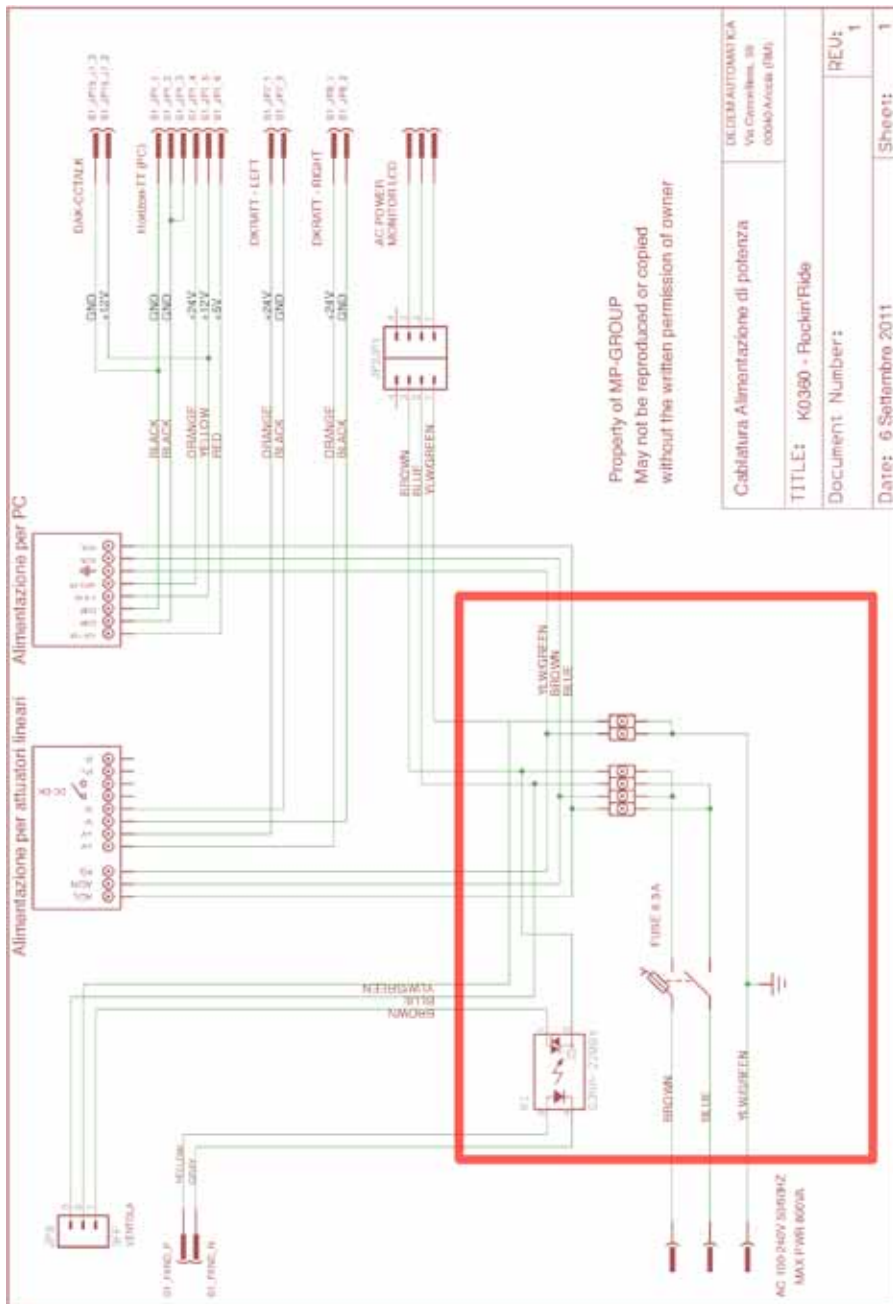

10.10 Computer diagram

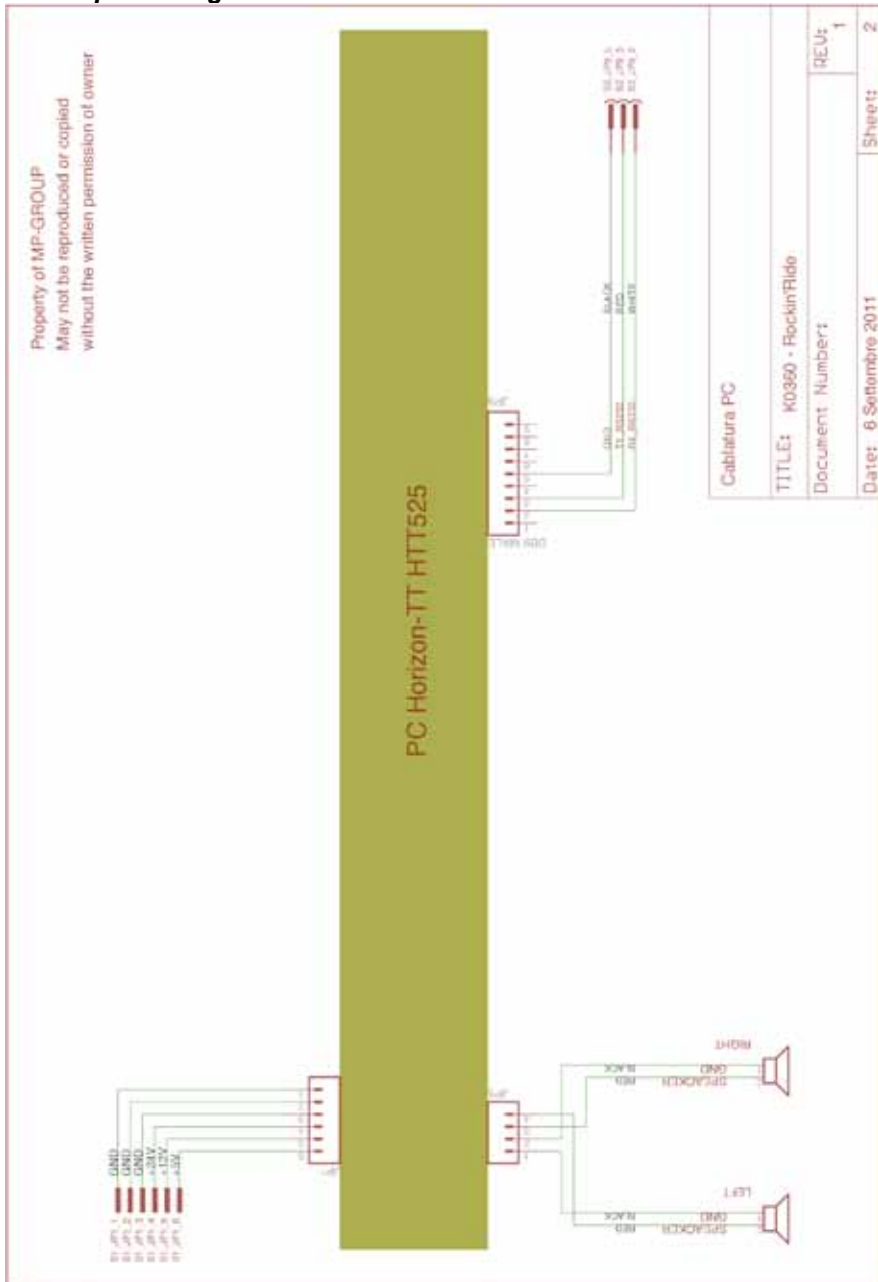

10.12 Front panel diagram

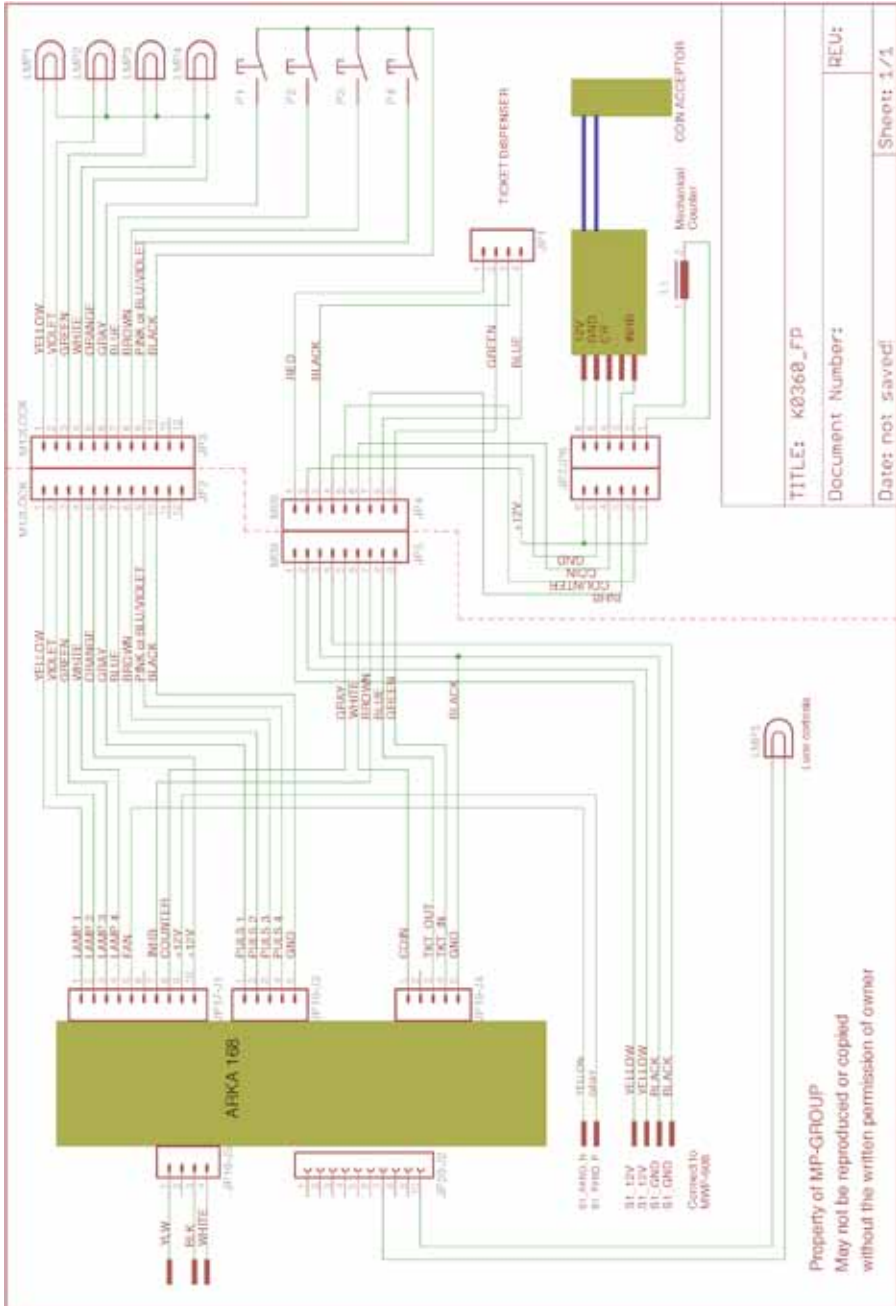

11 - PRODUCT DATA SHEET

	SCHEDA PRODOTTO ROCKIN' RIDE HELMET K0505
Dimensions	Width= 107 cm
	Length = 149 cm
	Height = 140 cm
Weight	160 kg
Maximum power adsorbed	550 W